

Department of Engineering
Tim Bryan, P.E., County Engineer

3137 South Liberty Street, Canton, MS 39046
Office (601) 790-2525 FAX (601) 859-3430

MEMORANDUM

December 15, 2021

To: Sheila Jones, Supervisor, District I
Trey Baxter, Supervisor, District II
Gerald Steen, Supervisor, District III
Karl Banks, Supervisor, District IV
Paul Griffin, Supervisor, District V

From: Tim Bryan, P.E., PTOE
County Engineer

Re: Centerpoint Energy Utility Permit
County Road Name, Calhoun Parkway

The Engineering Department recommends approval of the permit application for Centerpoint Energy to install 5155 LF of 6 in. natural gas main along Calhoun Parkway from Gluckstadt Road to just North of AutoBahn Loop.

SHEILA JONES
District One

TREY BAXTER
District Two

GERALD STEEN
District Three

KARL BANKS
District Four

PAUL GRIFFIN
District Five



PERMIT APPLICATION FOR THE CONSTRUCTION OR ADJUSTMENT OF A UTILITY WITHIN COUNTY ROAD RIGHT-OF-WAY

Utility Information: Utility Name: CenterPoint Energy

Address: 300 Executive BLVD City/State/Zip: Byram, MS, 39272

Contact Person: Bryant Williams Contact's Phone: 601-715-0571

Project Information: County Road Name: Calhoun PKWY
(If located within more than one road right-of-way, use Appendix 1 for additional descriptions)

Beginning Location: Calhoun PKWY Ending Location: Intersection on Gluckstadt Rd.

Length of Project: 5155' Section: 21 Township: 8N Range: 2E

Description of Work: Install 6in natural gas main on Calhoun PKWY, tie in to existing natural gas main Gluckstadt Rd.

Check Box if Appendix 1 is to be included as a part of this Application

Whereas the above stated Utility makes application to the **Madison County Board of Supervisors** for a Construction Permit. Attached hereto are drawings and plans for the construction of the above facilities located within Madison County owned public rights-of-way. Once stamped by the Madison County Engineering Department, these plans shall not be changed or altered without written approval of the County Engineer, or his representative. A copy of the approved permit and plans shall be on-site at all times during construction.

The Applicant Utility shall comply with all policies, procedures and construction practices as outlined in *A Policy for The Accommodation of Utility Facilities within the Right-of-Way of all Public County Roads* (hereinafter referred to as the "Policy"), as adopted on November 1, 2005, by the **Madison County Board of Supervisors**, and which is hereby made a part of this Application Agreement.

If facilities are to be located within the Rights-of-Way of the County-Federal or State Aid System, Applicant Utility also agrees to comply with applicable provisions of *S.O.P. No. SA II-2-8, Accommodation of Utilities on Rights-of-Way*, issued by the State Aid Engineer and dated July 1, 2005.

The Applicant Utility understands and agrees that, except as herein granted, no right, title, claim, or easement to said road right-of-way is granted by the issuance of this permit. If this Utility is listed in the general provisions of the Policy, it will be adjusted to comply with same without cost to the County, unless the variance from the Policy has been approved by the granting of the Permit pursuant to this Application.

The Applicant Utility further understands that the Utility's engineering, plant, or other personnel will be responsible for the staking and construction supervision of the work set out above and as shown on the attached plans. If work impacts traffic in any way, the appropriate traffic control shall be installed per the *Manual of Uniform Traffic Control Devices*, Latest Edition.

The Applicant Utility understands that the County Engineer, or his representative, may issue a Stop Work Order at any time if it is deemed that site conditions are not suitable for construction or if any of the requirements of this permit are not being met.

Many County Roads have variable Rights-of-Way and/or no Right-of-Way at all and are maintained under a Prescriptive Easement. It is the sole responsibility of the Applicant Utility to verify the existence and limits of public rights-of-way. If none exists, it is the

responsibility of the Applicant Utility to acquire an easement for their Facilities from the applicable property owner(s). Madison County in no way verifies the limits of Right-of-Way as shown on the permit application.

The Applicant Utility shall be responsible for all future maintenance and repair of the facilities installed under this permit. The Applicant Utility shall make future adjustments to, or relocate, the facilities located within road or highway right-of-way when required for road or highway widening or other road or highway construction at no cost to Madison County. The Applicant Utility shall relocate said utilities within sixty (60) days of notification by County by registered mail, return receipt requested, unless otherwise designated by the County Engineer. Further, any maintenance, repair, or construction shall be done in such a manner as to occasion no unreasonable interference with the normal flow and safety to traffic and at the expense of the utility company. When reasonable care has been taken to locate said utility facilities within the right-of-way, the Applicant Utility understands that any damages caused by routine maintenance and construction by County forces shall be borne by the Applicant Utility.

The Applicant Utility further agrees to indemnify and hold Madison County harmless for any and all claims, accidents, damages, liabilities and expenses occasioned wholly, or in part, by any act or omission of applicant, its agents or employees. In case County shall, without fault on its own part, be made a party to any litigation commenced by or against applicant, then applicant shall protect and hold County harmless, and shall pay all costs, expenses and reasonable attorney's fees incurred or paid by County in connection with said litigation.

All underground facilities shall be installed at a depth equal to or greater than 48" below the lowest adjacent grade.

All pipes carrying liquid shall be encased under County maintained roads.

WITNESS the signature of the Applicant this the 15 day of December, 2021.

By: Bryant Williams
(Applicant Signature)

Title: Engineer Intern

Note: Applicant must be an employee of the Utility named in this application. The Madison County Board of Supervisors will not recognize a Contractor, Subcontractor, Agent, or Consulting Engineer as the Applicant. Utility Company shall be fully responsible for all work performed under this application.

I, or my authorized representative, have reviewed this application and determined that the drawing, sketches, and plans submitted by the Applicant meet the requirements of A Policy for The Accommodation of Utility Facilities within the Right-of-Way of all Public County Roads.

APPROVED
By *timothy.bryan at 10:36 am, Jan 26, 2022*

Tim Bryan, P.E.
County Engineer

AGREED TO AND APPROVED BY:

Madison County Board President

Date: _____

ENTERED INTO THE MINUTES OF THE BOARD OF SUPERVISORS OF MADISON COUNTY, MISSISSIPPI ON THIS _____ DAY OF _____, 20_____.

Appendix 1

County Road Name: _____
Beginning Location: _____ Ending Location: _____
Length of Project: _____ Section: _____ Township: _____ Range: _____
Description of Work: _____

County Road Name: _____
Beginning Location: _____ Ending Location: _____
Length of Project: _____ Section: _____ Township: _____ Range: _____
Description of Work: _____

County Road Name: _____
Beginning Location: _____ Ending Location: _____
Length of Project: _____ Section: _____ Township: _____ Range: _____
Description of Work: _____

County Road Name: _____
Beginning Location: _____ Ending Location: _____
Length of Project: _____ Section: _____ Township: _____ Range: _____
Description of Work: _____

County Road Name: _____
Beginning Location: _____ Ending Location: _____
Length of Project: _____ Section: _____ Township: _____ Range: _____
Description of Work: _____

NOTICE!
48 HOURS BEFORE YOU DIG
CALL 811
TO LOCATE UTILITY LINES

- NOTES:**
1. TEST ALL MAIN / SERVICES TO 100 PSIG ESTABLISHING A 60 PSIG MAOP.
 2. FOLLOW CNP C&S MANUAL TESTING PROCEDURES.
 3. USE PRESSURE GAUGES ON ALL BY-PASSES AND ON ALL TIE-INS.
 4. INSTALL LINE MARKERS AND TRACER WIRE TEST LEADS AT SUITABLE LOCATIONS.
 5. INSTALL NEW GAS MAIN LINES WITHIN THE LAST 1' - 5' OF PUBLIC RIGHT OF WAY AS INDICATED AT A DEPTH OF 3' - 5' UNLESS OTHERWISE INDICATED.
 6. HAVE ALL ROW STAKED PRIOR TO CONSTRUCTION.
 7. ANY FIELD GENERATED CHANGE TO THIS DESIGN SHALL FOLLOW THE ENGINEERING GUIDE-FIELD GENERATED CHANGE PROCESS WHICH MAY REQUIRE ADDITIONAL APPROVAL FROM ENGINEERING PRIOR TO PROCEEDING.

REVIEWED BY:

DATE	INITIALS
8/16/21	
8/16/21	<i>SM</i>

Checklist Information
Corrosion:
PER CORROSION, NO CP REINFORCEMENT REQUIRED

Calhoun Station
Gluckstadt, Madison County, MS
DESIGNER: MICHAEL MANN
PHONE#: 601-799-2413
DRAWN BY: MICHAEL MANN
DESIGN DATE: 07/28/21
SCALE: 1" = 120'
SHEET: 1 OF 1

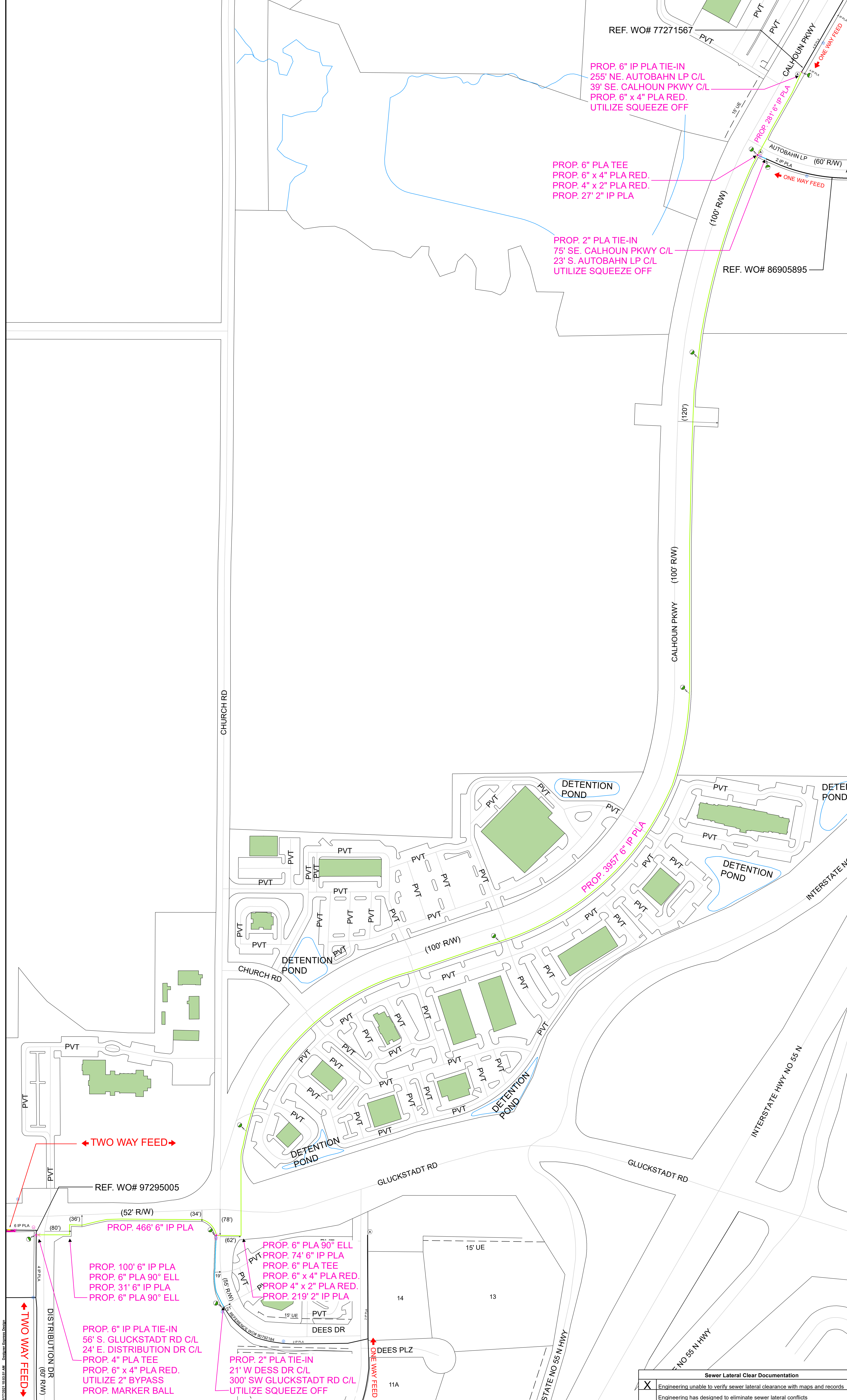

REF. WO# 77271567
PROP. 6" IP PLA TIE-IN
255' NE. AUTOBAHN LP C/L
39' SE. CALHOUN PKWY C/L
PROP. 6" x 4" PLA RED.
UTILIZE SQUEEZE OFF

PROP. 6" PLA TEE
PROP. 6" x 4" PLA RED.
PROP. 4" x 2" PLA RED.
PROP. 27' 2" IP PLA

PROP. 2" PLA TIE-IN
75' SE. CALHOUN PKWY C/L
23' S. AUTOBAHN LP C/L
UTILIZE SQUEEZE OFF

REF. WO# 86905895

PROP. 6" PLA 90° ELL
PROP. 74' 6" IP PLA
PROP. 6" PLA TEE
PROP. 6" x 4" PLA RED.
PROP. 4" x 2" PLA RED.
PROP. 219' 2" IP PLA

PROP. 100' 6" IP PLA
PROP. 6" PLA 90° ELL
PROP. 31' 6" IP PLA
PROP. 6" PLA 90° ELL

PROP. 6" IP PLA TIE-IN
56' S. GLUCKSTADT RD C/L
24' E. DISTRIBUTION DR C/L
PROP. 4" PLA TEE
PROP. 6" x 4" PLA RED.
UTILIZE 2" BYPASS
PROP. MARKER BALL

PROP. 2" PLA TIE-IN
21' W DESS DR C/L
300' SW GLUCKSTADT RD C/L
UTILIZE SQUEEZE OFF

Sewer Lateral Clear Documentation
 Engineering unable to verify sewer lateral clearance with maps and records
Engineering has designed to eliminate sewer lateral conflicts